

**51799 & 55799
Series/Series/Seria**

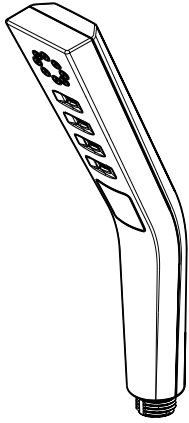

**Pivotall™ Hand Shower 3
Setting
Pieza de Mano Pivotall™ 3
Ajustes
Douche à main Pivotall™ 3
réglages**

59799-PK▲
Hand Shower
Regadera de Mano
Douche à main

**51421, 54421 &
55421
Series/Series/Seria**



**Hand Shower Single Setting
Pieza de Mano Un Ajuste
Douche à main Un réglage**

59421-PK▲
Hand Shower
Regadera de Mano
Douche à main

**51549, 54424-PK &
55424
Series/Series/Seria**

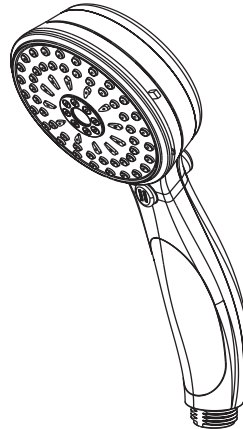

**Hand Shower 9 Setting
Pieza de Mano 9 Ajuste
Douche à main 9 réglage**

59424-PK▲
Hand Shower
Regadera de Mano
Douche à main

**55424-18-PK
Series/Series/Seria**

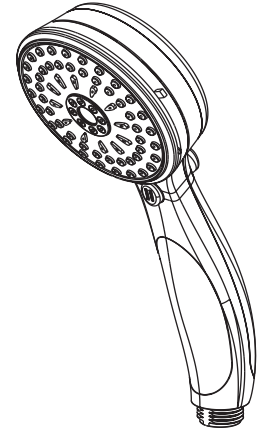

**Hand Shower 9 Setting
Pieza de Mano 9 Ajuste
Douche à main 9 réglage**

59424-18-PK▲
Hand Shower
Regadera de Mano
Douche à main

**51559, 55445,
54445-PK
Series/Series/Seria**

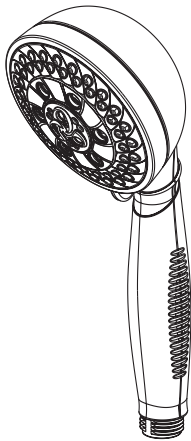

**Hand Shower 5 Setting
Pieza de Mano 5 Ajuste
Douche à main 5 réglage**

59445-PK▲
Hand Shower
Regadera de Mano
Douche à main

**51308, 55433
Series/Series/Seria**

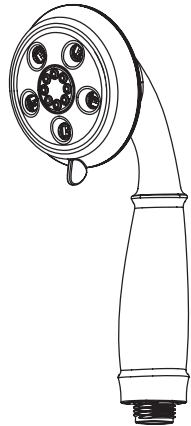

**Hand Shower 3 Setting
Pieza de Mano 3 Ajuste
Douche à main 3 réglage**

59433-PK▲
Hand Shower
Regadera de Mano
Douche à main

**51386, 55386
Series/Series/Seria**



**Hand Shower 3 Setting
Pieza de Mano 3 Ajuste
Douche à main 3 réglage**

59386▲
Hand Shower
Regadera de Mano
Douche à main

**51589, 51708, 51751,
59716, 59346-PK,
59426-PK
Series/Series/Seria**

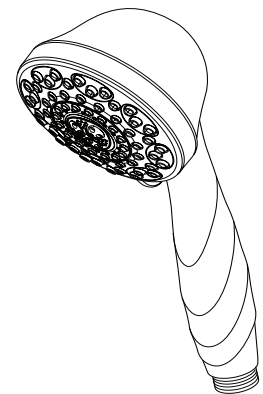

**Hand Shower 7 Setting
Pieza de Mano 7 Ajuste
Douche à main 7 réglage**

59426-PK▲
Hand Shower
Regadera de Mano
Douche à main

▲Specify Finish / Especificque el Acabado / Précisez le Fini

54434-18-PK
Series/Series/Seria

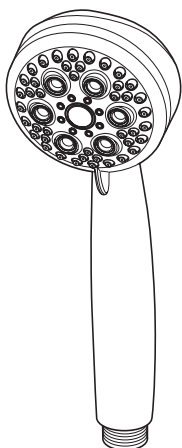

Hand Shower 5 Setting
Pieza de Mano 5 Ajuste
Douche à main 5 réglage

59434-18-PK▲
Hand Shower
Regadera de Mano
Douche à main

54436-PK, 55436,
51559-DS
Series/Series/Seria

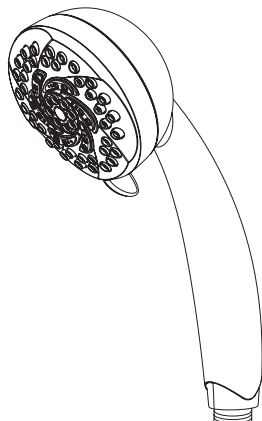

Hand Shower 5 Setting
Pieza de Mano 5 Ajuste
Douche à main 5 réglage

59436-PK▲
Hand Shower
Regadera de Mano
Douche à main

51361
Series/Series/Seria

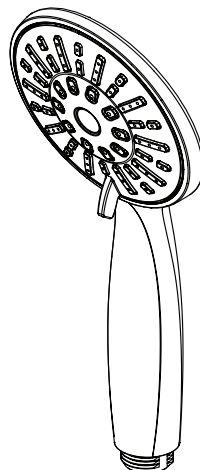

Hand Shower 4 Setting
Pieza de Mano 4 Ajuste
Douche à main 4 réglage

59361-PK▲
Hand Shower
Regadera de Mano
Douche à main

59344-B18-PK
Series/Series/Seria

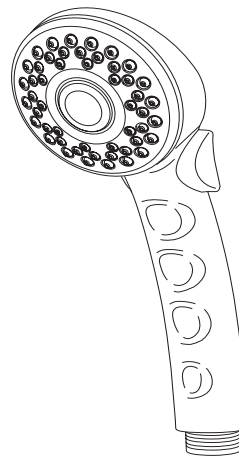

Hand Shower 2 Setting
Pieza de Mano 2 Ajuste
Douche à main 2 réglage

59462-B18-PK▲
Hand Shower
Regadera de Mano
Douche à main

59410-B-PK
Series/Series/Seria

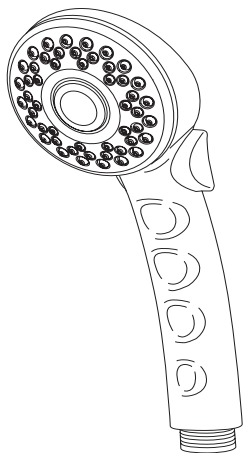

Hand Shower 2 Setting
Pieza de Mano 2 Ajuste
Douche à main 2 réglage

59462-B-PK▲
Hand Shower
Regadera de Mano
Douche à main

59310-18-PK
Series/Series/Seria

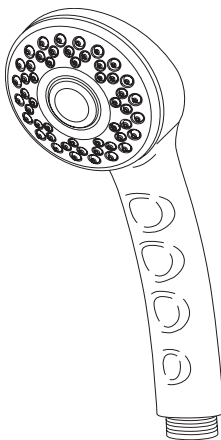

Hand Shower Single Setting
Pieza de Mano Un Ajuste
Douche à main Un réglage

59462-18-PK▲
Hand Shower
Regadera de Mano
Douche à main

51552 & 55552
Series/Series/Seria

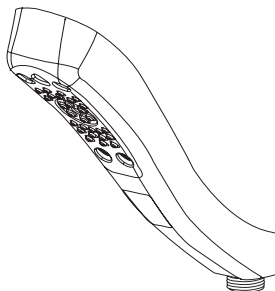

Hand Shower 4 Setting
Pieza de Mano 4 Ajustes
Douche à main 4 réglages

59552-PK▲
Hand Shower
Regadera de Mano
Douche à main

51140 & 55140
Series/Series/Seria

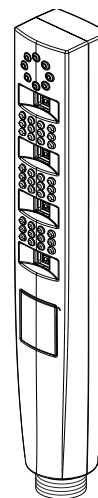

Hand Shower 4 Setting
Pieza de Mano 4 Ajuste
Douche à main 4 réglage

59140-PK▲
Hand Shower
Regadera de Mano
Douche à main

▲Specify Finish / Especificar el Acabado / Précisez le Fini

55011 & 57011
Series/Series/Seria

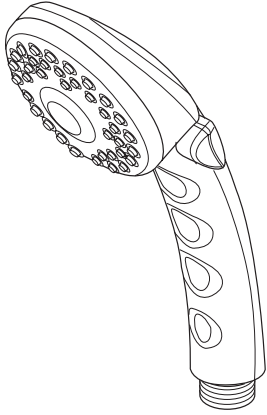

Transitional Hand Shower
2 Setting
Pieza de Mano Transicional
2 Ajustes
Douche à main Transicional
2 réglages

RP7405▲
Hand Shower
Regadera de Mano
Douche à main

57014 & 56613
Series/Series/Seria

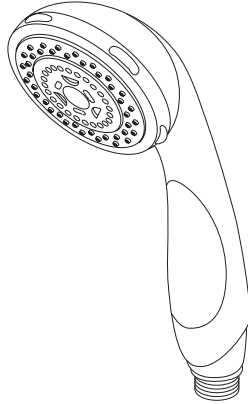

Transitional Hand Shower
3 Setting
Pieza de Mano Transicional
3 Ajustes
Douche à main Transicional
3 réglages

RP48769▲
Hand Shower
Regadera de Mano
Douche à main

55021,57021& 54613
Series/Series/Seria

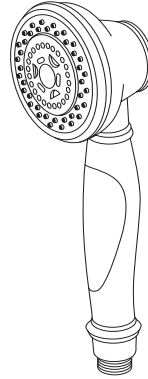

Traditional Hand Shower
3 Setting
Pieza de Mano Tradicional
3 Ajustes
Douche à main Traditional
3 réglages

RP48770▲
Hand Shower
Regadera de Mano
Douche à main

55051 & 57051
Series/Series/Seria

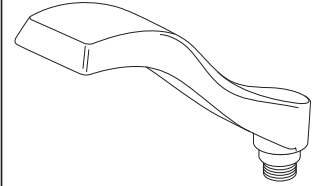

Dryden™ Hand Shower
Single Setting
Pieza de Mano Dryden™
Un Ajuste
Douche à main Dryden^{MC}
Un réglage

RP52589▲
Hand Shower
Regadera de Mano
Douche à main

55085 & 57085
Series/Series/Seria

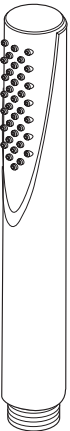

Trinsic™ / Compel™
Single Function
Pieza de Mano Trinsic™ /
Compel™ Una Función
Douche à main Trinsic^{MC} /
Compel^{MC} Une fonction

RP73384▲
Hand Shower
Ducha Manual

55013
Series/Series/Seria

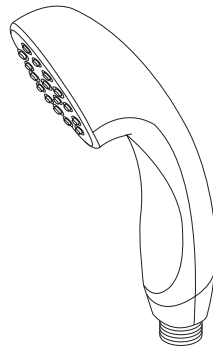

Transitional Hand Shower
Single Setting
Pieza de Mano Transicional
Un Ajuste
Douche à main Transicional
Un réglage

RP46683▲
Hand Shower
Ducha Manual

55020
Series/Series/Seria

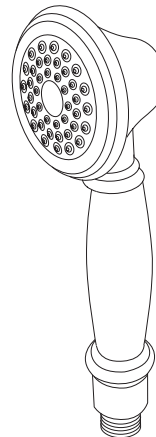

Traditional Hand Shower
Single Setting
Pieza de Mano Tradicional
Un Ajuste
Douche à main Traditional
Un réglage

RP46680▲
Hand Shower
Ducha Manual

55530 & 57530
Series/Series/Seria



Vero™ Hand Shower
Single Setting
Pieza de Mano Vero™
Un Ajuste
Douche à main Vero^{MC}
Un réglage

RP62954▲
Hand Shower
Ducha Manual

▲Specify Finish / Especificque el Acabado / Précisez le Fini

57923 & 59210
Series/Series/Seria

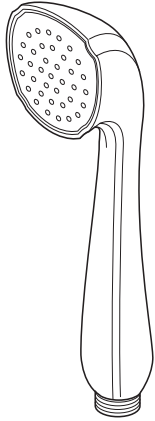

Addison® Hand Shower
Single Setting
Pieza de Mano Addison®
Un Ajuste
Douche à main Addison®
Un réglage

RP61283▲
Hand Shower
Regadera de Mano
Douche à main

51567 & 55567
Series/Series/Seria

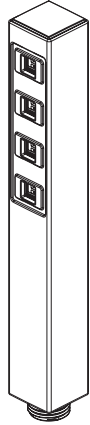

Ara™ Hand Shower
Single Setting
Pieza de Mano Ara™
Un Ajuste
Douche à main Ara™
Un réglage

59567-PK▲
Hand Shower
Regadera de Mano
Douche à main

51552, 54613, 55020, 55021, 55051, 55085, 55530, 55552, 57021, 57051, 57085, 57530, 57923, 51140, 55140 51567, 55567, 59210, 51799, 55799, 51421, 51549, 55424, 54424-PK, 54424-18-PK, 51559, 55445, 54445-PK, 51308, 55433, 51579, 55421, 55013, 57014, 56613, 51708, 51589, 59346-PK, 59716, 54434-18-PK, 51599-DS, 55436-PK, 54436-PK, 59348-18-PK, 57011, 59410-B-PK, 55011, 59344-B18-PK, 59310-18-PK, 55386 & 51386
Series/Series/Seria

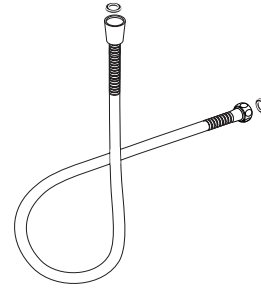

U495D -▲60-PK
Hose & Gaskets
Manguera y Empaques
Tuyau souple et joints

55011, 55013, 55020, 55021, 55085, 57923 & 55386
Series/Series/Seria

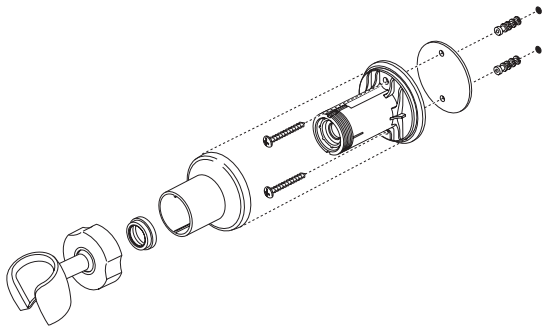

RP61294▲
Mounting Bracket
Consola de montaje
Support

55424, 55445, 55433, 55421, 59716
Series/Series/Seria

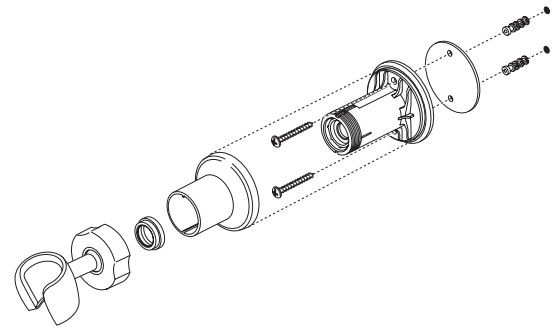

U4005-PK▲
Mounting Bracket
Consola de montaje
Support

55552, 55567, 55051, 55140, 55530 & 55799
Series/Series/Seria

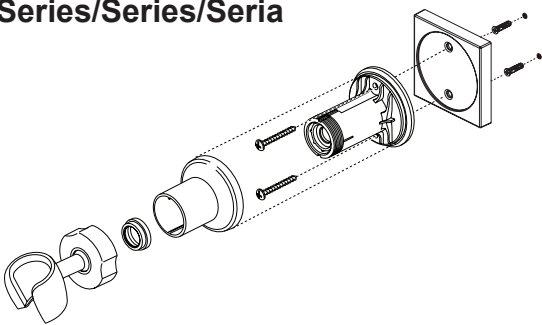

U4010-PK▲
Hand shower holder
Teleducha titular
Support douchette

54424-PK, 54424-18-PK, 56613, 59346-PK, 55434-18-PK, 54436-PK, 59344-B18-PK
Series/Series/Seria

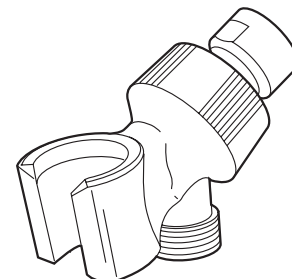

U3401-PK▲
Shower Arm Mount
Soporte para brazo de ducha
Support de bras de douche

▲Specify Finish / Especificque el Acabado / Précisez le Fini

57021
Series/Series/Seria

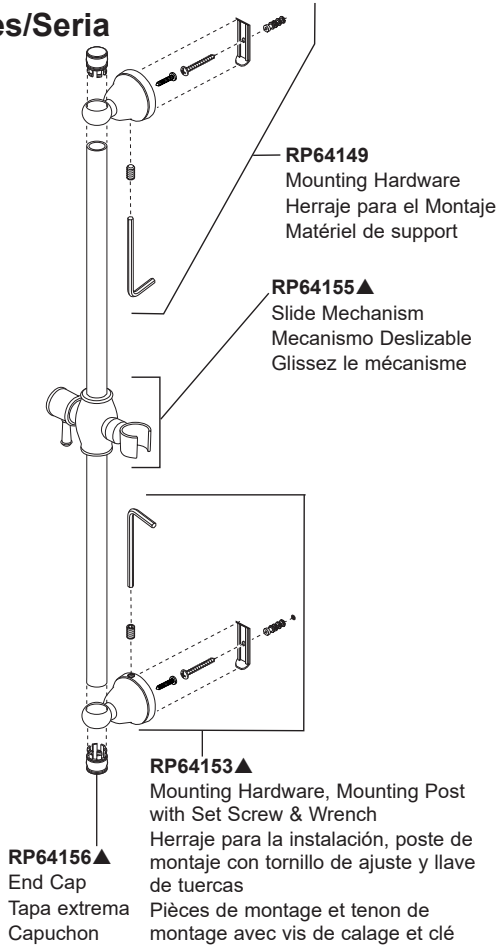

57011, 57014 & 57085
Series/Series/Seria

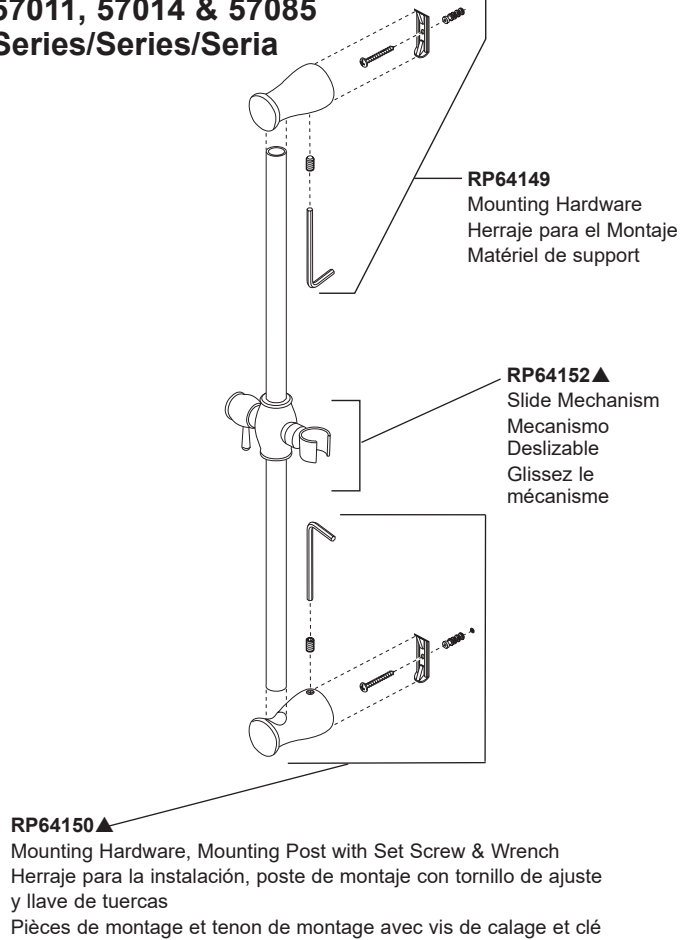

51140, 51552, 51567, 57051, 57530 & 51799
Series/Series/Seria

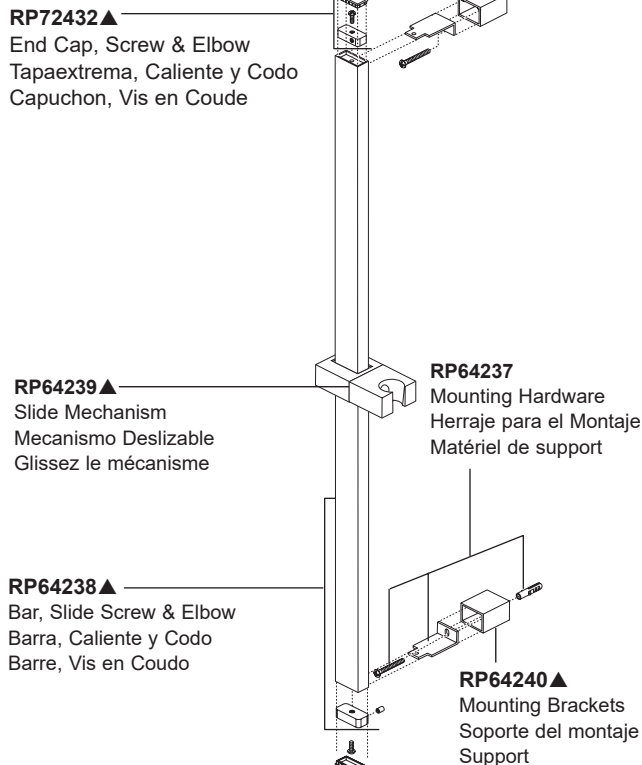

51549, 51559, 51579, 51589, 51599-DS & 51386
Series/Series/Seria

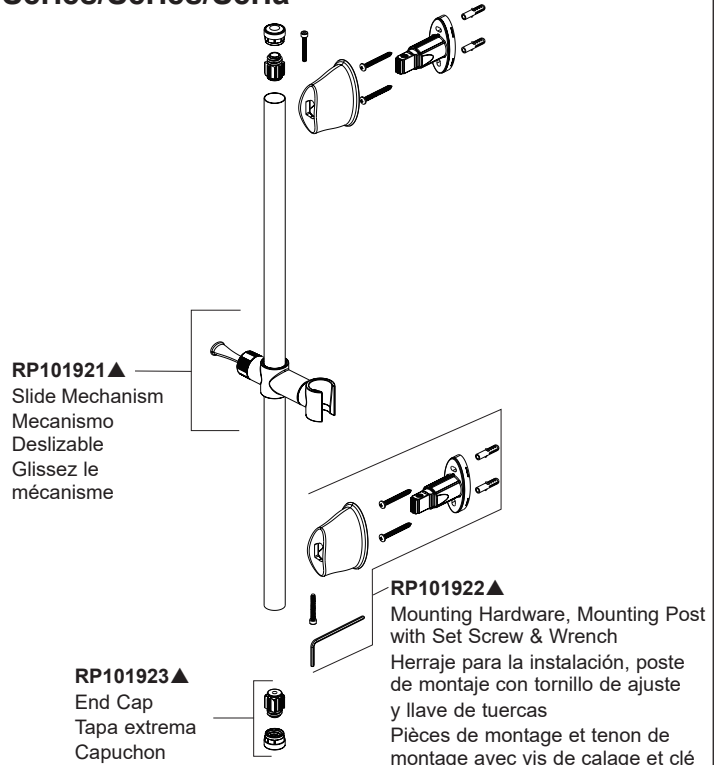

▲Specify Finish / Especificque el Acabado / Précisez le Fini

51361
Series/Series/Seria

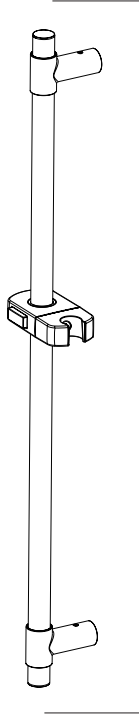

56361▲
Slide Bar, Slide Mechanism, Mounting
Post and Hardware
Barra deslizante, mecanismo de
deslizamiento, poste de montaje y
hardware
Barre de diapositives, mécanisme de
diapositives, poste de montage et matériel

Model/Modelo/Modèle
R10000
Series/Series/Seria

Replacement Parts
Piezas de Repuesto
Pièces de rechange

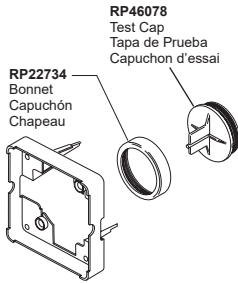

RP22734
 Bonnet
 Capuchón
 Chapeau

RP46078
 Test Cap
 Tapa de Prueba
 Capuchon d'essai

RP101820
 Screws (2)
 Tornillos (2)
 Vis (2)

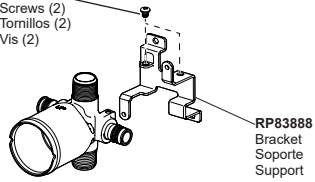

RP83888
 Bracket
 Soporte
 Support

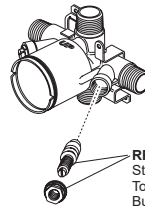

RP50366
 Stops (2)
 Topes (2)
 Butées (2)

RP46079*
 Reusable Test Plug
 (Sold as RP Only)
 Tapón de Prueba
 Reutilizable (Sólo se
 vende como Pieza de
 Repuesto)
 Bouchon d'essai
 réutilisable (pièce de
 rechange seulement)



RP47202
 Thin Wall Mounting Kit
 Soporte de montaje fino de la pared
 Support mince de mur

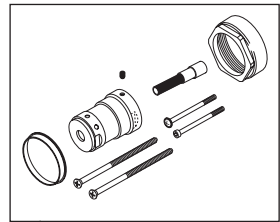
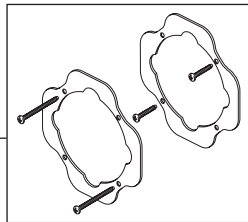

RP75136
 Extension Kit - For use with T17T Tempassure®
 models only (adds 1 3/4" depth)
 Kit de extensión - Sólo para uso con los
 modelos T17T Tempassure®
 (se agrega 1 3/4 pulgada de profundidad)
 Trousse de rallonge - Pour utilisation avec les
 modèles T17T Tempassure® seulement.
 (ajoute une profondeur de 1 3/4 po)

*Used to plug one inlet side (Hot or Cold) to prevent cross flow when checking for leaks before the cartridge is installed. Insert into the inlet, place test cap and use the bonnet to secure in place.

*Tapaban una entrada lateral (caliente o frío) para prevenir flujo cruzado cuando la comprobación para saber si hay escapes antes del cartucho está instalada. El relleno en la entrada, casquillo de la prueba del lugar y utiliza el capo para asegurar en lugar.

*Branchaient une admission latérale (chaud ou froid) pour empêcher l'écoulement en travers quand la vérification les fuites avant la cartouche est installée. L'insertion dans l'admission, chapeau d'essai d'endroit et emploient le capot pour fixer en place.

Model / Modelo / Modèle

R11000

Series/Series/Seria

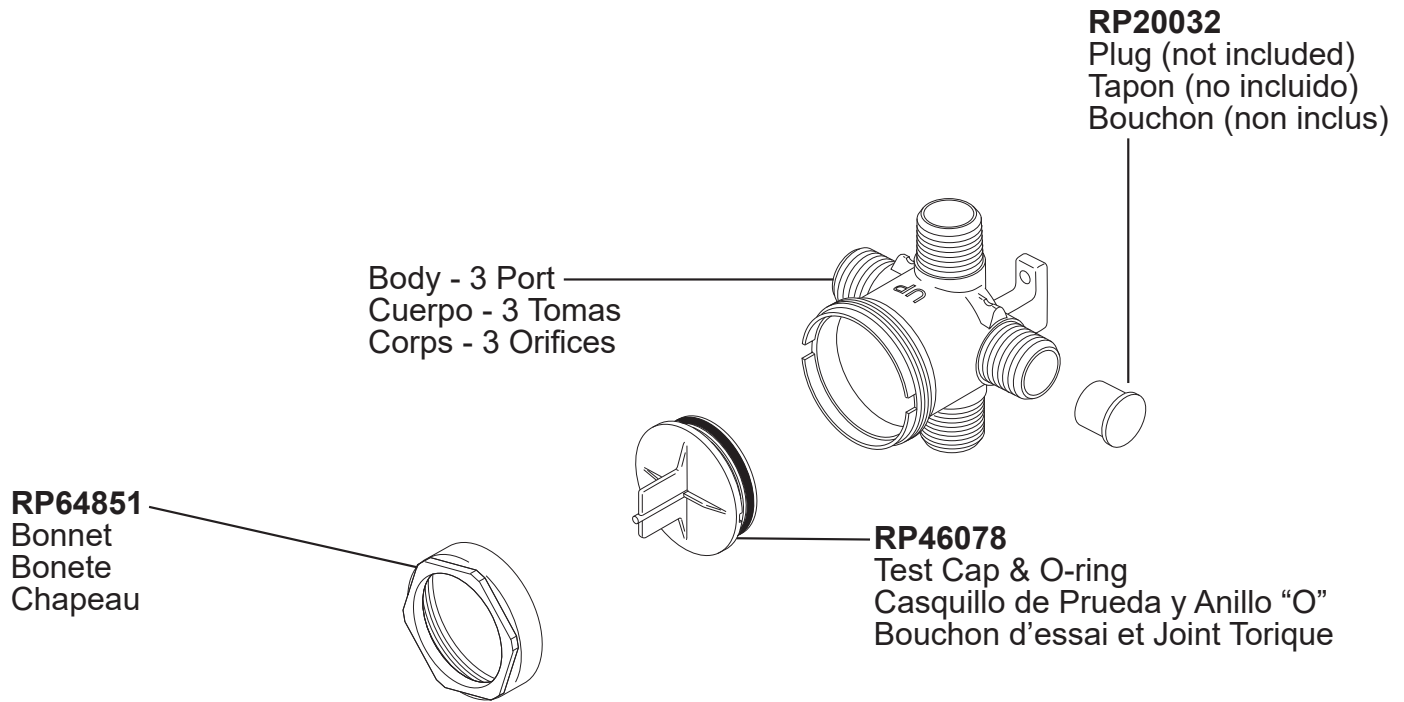

Models/Modelos/Modèles
T11859 & T11959
 Series/Series/Seria
Trinsic®

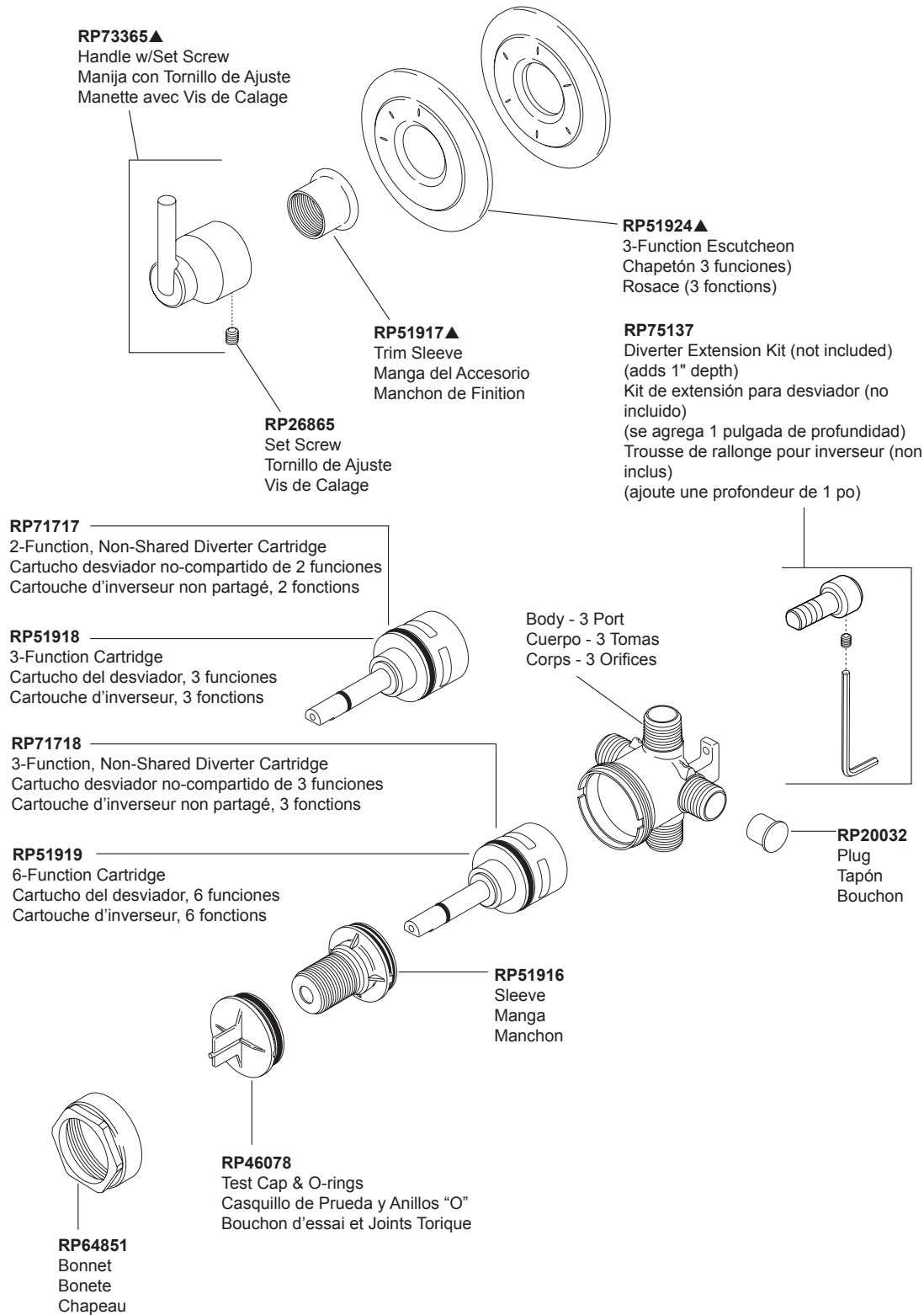

Using New Trim With
 Rough R11600

Para el uso de un accesorio nuevo
 con tuberías internas R11600

Utilisation de la nouvelle finition
 avec les soupapes R11600

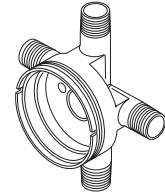

R11600

If you have **R11600** installed you will need to order **RP37902** (3 function stem extender) OR **RP37903** (6 function stem extender) and **RP37890** (extension screw) to use the new trim.

Si usted tiene instalado la pieza **R11600**, necesitará ordenar **RP37902** (extensión de espiga de 3 funciones) o **RP37903** (extensión de espiga de 6 funciones) y **RP37890** (tornillo de extensión) para utilizar el accesorio nuevo.

Si vous avez installé l'article **R11600**, vous devez commander les articles **RP37902** (rallonge de tige pour soupape à 3 fonctions) OU **RP37903** (rallonge de tige pour soupape à 6 fonctions) et **RP37890** (vis de rallonge) et les utiliser avec la nouvelle finition.

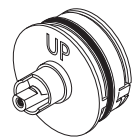

RP37902
 3 Function stem extender
 Extensión para la espiga -
 funciones 3
 Rallonge de tige - 3 fonctions

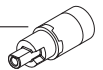

RP37903
 6 Function stem extender
 Extensión para la espiga -
 funciones 6
 Rallonge de tige - 6 fonctions

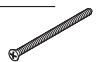

RP37890
 Extension Screw
 Tornillos de Extension
 Vis de Rallonge

Models/Modelos/Modèles
T14059-▲, T14159-▲, T14259-▲, T14459-▲,
T14058-▲, T14158-▲, T14258-▲ & T14458-▲
Series/Series/Seria
Trinsic®

STOP!

If you are unfamiliar with the version of shower, refer to escutcheon design for compatible replacement parts.

Si no está familiarizado con la versión de la ducha, consulte el diseño del escudo para obtener piezas de repuesto compatibles.

Si vous n'êtes pas familier avec la version de la douche, reportez-vous à la conception de l'écusson pour les pièces de rechange compatibles.

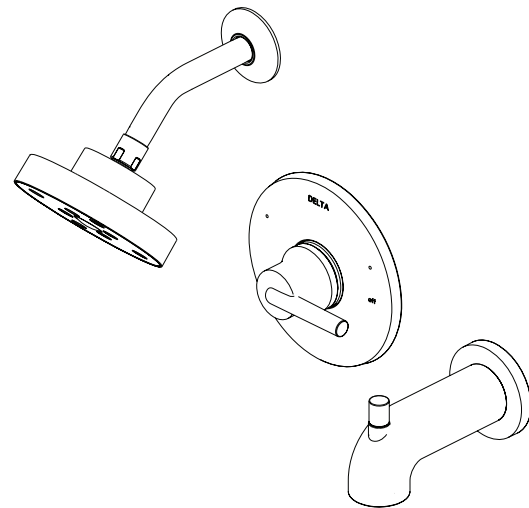

These parts are not interchangeable - Reference your escutcheon design to ensure correct parts.
Estas piezas no son intercambiables; Haga referencia al diseño de su escudo para asegurarse de que las piezas sean correctas.
Ces pièces ne sont pas interchangeables – Référez le design de votre rosace pour vous assurer que les pièces sont correctes.

Models/Modelos/Modèles
T14059-▲, T14159-▲, T14259-▲, T14459-▲,
T14058-▲, T14158-▲, T14258-▲ & T14458-▲
 Series/Series/Seria
Trinsic®

For models produced AFTER 03/10/2025.
Para los modelos producidos DESPUÉS del 10/03/2025.
Pour les modèles produits APRÈS le 10/03/2025.

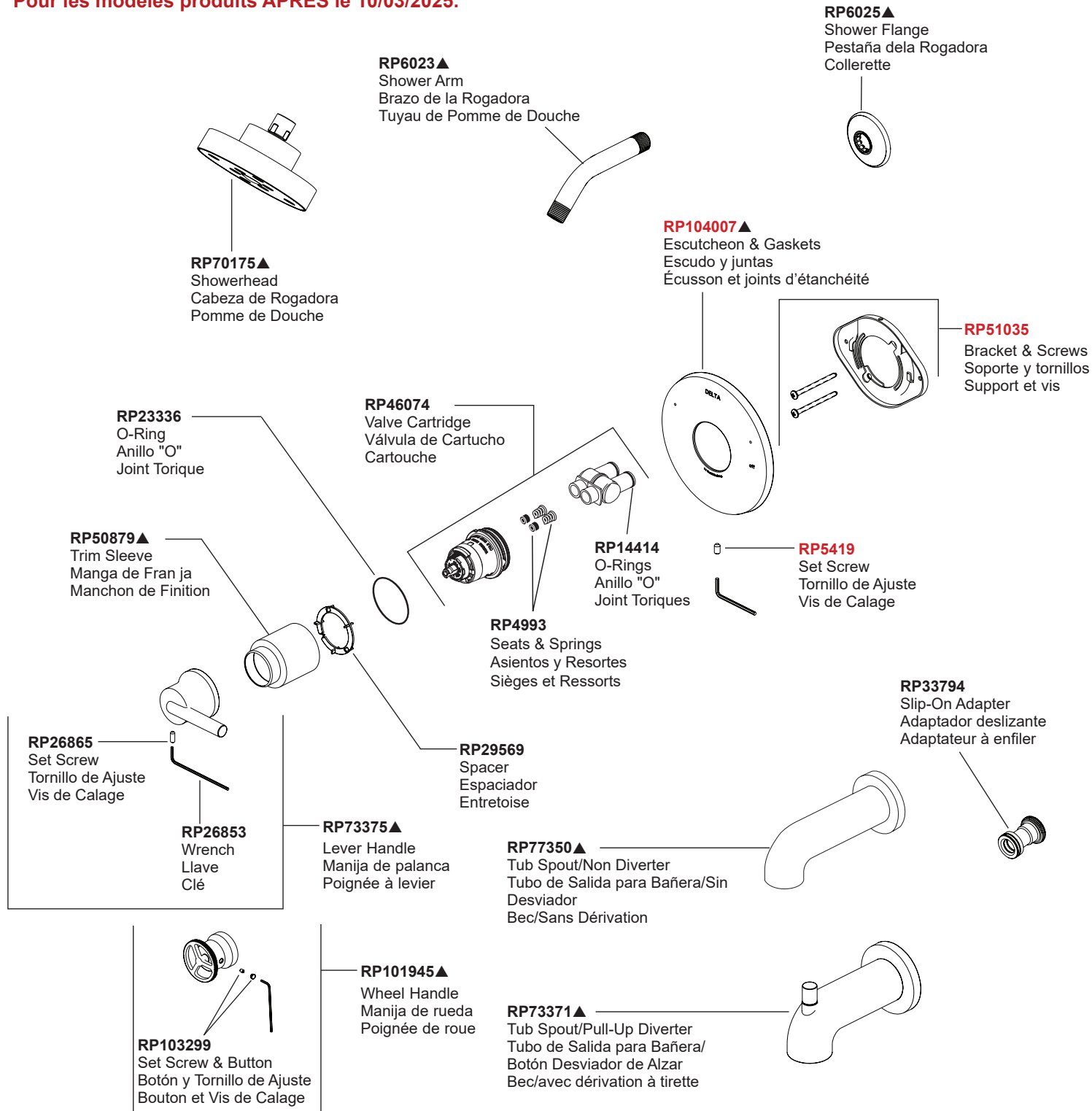

Models/Modelos/Modèles
T14059-▲, T14159-▲, T14259-▲, T14459-▲,
T14058-▲, T14158-▲, T14258-▲ & T14458-▲
 Series/Series/Seria
Trinsic®

For models produced BEFORE 03/10/2025.
Para los modelos fabricados ANTES del 10/03/2025.
Pour les modèles produits AVANT le 10/03/2025.

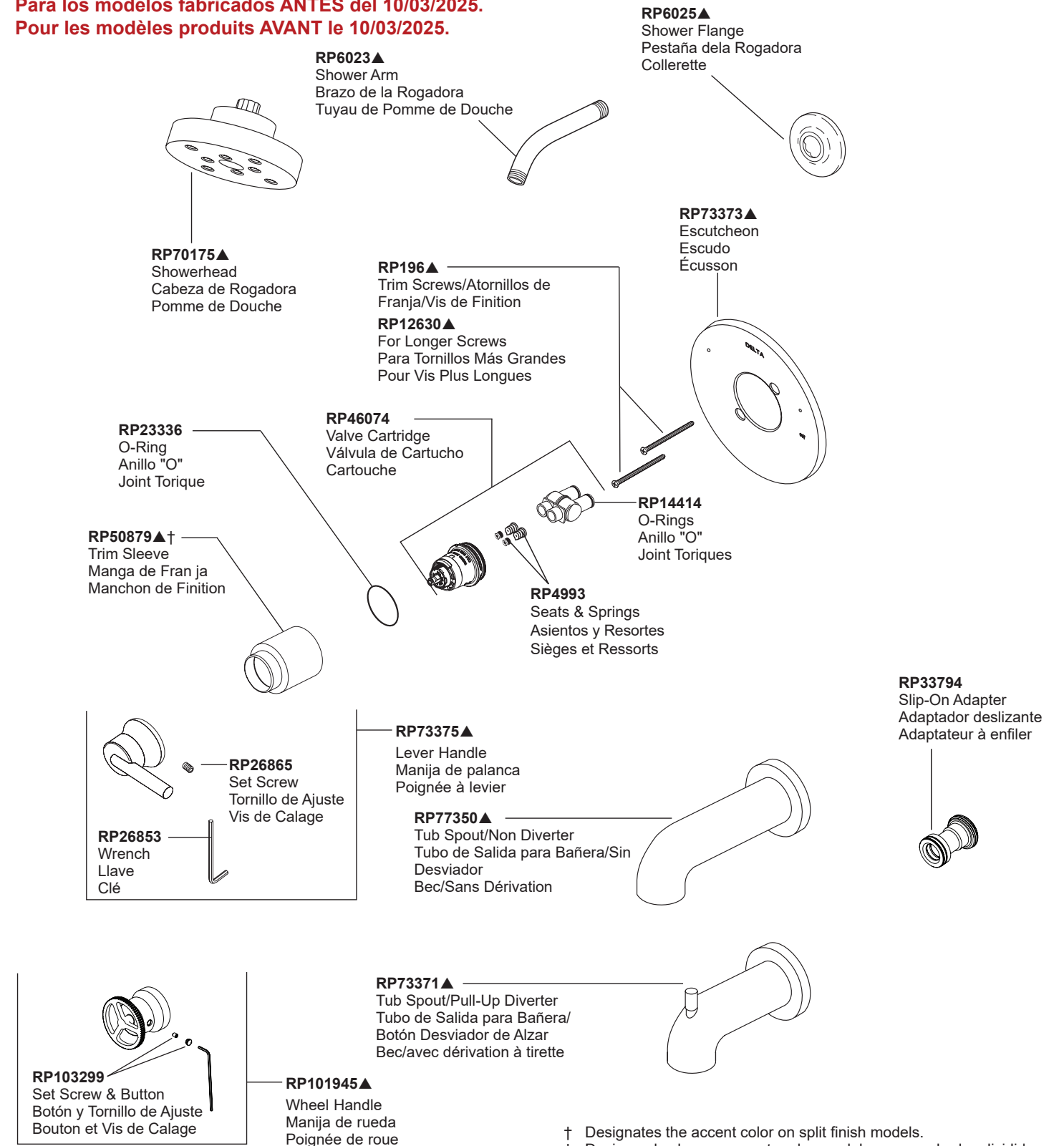

† Designates the accent color on split finish models.
 † Designa el color para acentuar los modelos con acabados divididos.
 † Désigne la couleur contrastante sur les modèles à deux finis